

INSTALLATION REQUIREMENTS PER USPS STD-4C

- 1. AT LEAST ONE CUSTOMER MAILBOX COMPARTMENT SHALL BE POSITIONED LESS THAN 48" ABOVE FINISHED FLOOR (AFF).
- 2. NO PARCEL LOCKER COMPARTMENT (INTERIOR BOTTOM SHELF) SHALL BE POSITIONED LESS THAN 15" AFF.
- 3. NO CUSTOMER MAILBOX LOCK SHALL BE LOCATED MORE THAN 67" AFF.
- 4. NO CUSTOMER MAILBOX COMPARTMENT (INTERIOR BOTTOM SHELF) SHALL BE POSITIONED LESS THAN 28" AFF.

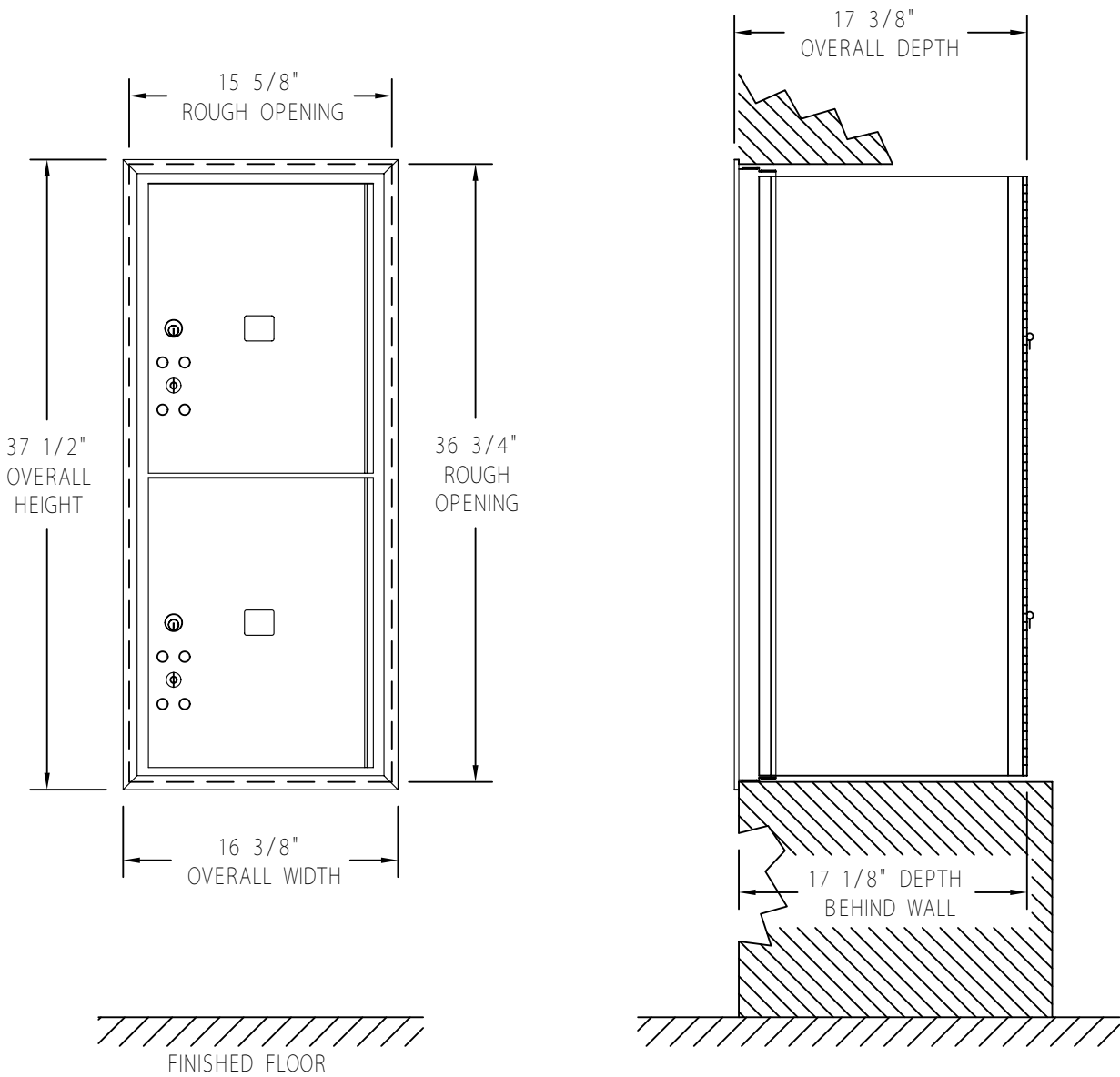

<div>DRAWN</div> <div>WCL</div>		<div>4C STANDARD HORIZONTAL MAILBOXES</div> <div>3700 SERIES REAR LOADING</div> <div>AVAILABLE FOR USPS ACCESS OR PRIVATE ACCESS</div>	<div>(2) PL5 PARCEL LOCKERS</div>	<div>MODEL</div> <div>3710S - 2P</div>
<div>DATE</div> <div>5/6/2013</div>				<div>DRAWING NO.</div> <div>CAD_3710S - 2PRL</div>
<div>CAD FILE SCALE</div> <div>1 : 1</div>				